

Door handle

The cylinder lock is easily fitted to our mesh, pc or steel sheet doors and includes a lock case from SAG. The locking tube as well as the striking plate, are reinforced with a welded steel cover to reduce the risk for manipulation. Extra hooks makes it impossible to open the door by pulling it sidewise.

Complement with any of our variants of profile cylinder; double or single with same or different lockings, or contact your local locksmith for easy maintenance solutions.

The Cylinder Lock can be supplied pre-mounted on our single hinged doors, or supplied as parts in a lock kit for mounting on site.



FACTS

Dimensions (approx.)

W x H x D

70 mm x 290 mm x 30 mm

The lock is supplied in a kit for easily mounting on site, fitting to our various door types.

Based on doors with 60x40 posts;

- hinged door - Kit 5710
- double hinged door - Kit 5730
- sliding, and sliding dbl rail door - Kit 5720
- dbl sliding, telescopic, linear and on wheels - Kit 5780

Based on doors with 80x80 posts;

- hinged door - Kit 5750
- double hinged door - Kit 5730
- sliding, and sliding dbl rail door - Kit 5760
- double sliding and sliding on wheels - Kit 5780
- telescopic sliding /hinged - Kit 5780

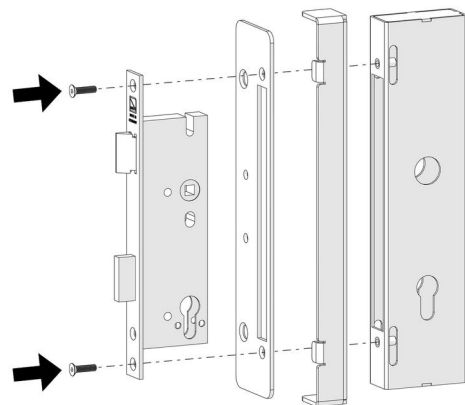

PROFILE CYLINDER

Article number:	Description:
89051081	Profile cylinder, double different locking
89051089	Profile cylinder, double same locking

Article number:	Description:
89051095	Profile cylinder, single different locking
89051096	Profile cylinder, single same locking

